



件 : -01-19-A-07-A08

: 02

: 2018.11.21

1 共 3

## PD300-TO25-BL-2pin Series

### Features:

D C  
C-B 1310 ; -B

### Applications:

D

### Specifications:

#### Absolute Maximum Ratings:

Parameter	Symbol	Min.	Max.	Unit
		—	20	
C		—	50	A
	A	—	30	
		-40	+85	°C
		-40	+85	°C
	—	—	260	°C
	—	—	10	

#### Characteristics: (Ta=25°C unless otherwise noted)

Parameter	Symbol	Test Conditions	Min.	Typ.	Max.	Unit
A D	D	—	—	300	—	
B	B	=-10 B , , =5	400	600		
	@1310	=5	0.80	0.9		A/
	@1550	=5	0.90	0.9		A/
D C	D	=5	—	0.1		A
C C	C	=5 , =1	—	4.0	6.0	
		—	1100	—	1620	

:// . - .

: +86-592-3898601

: +86-592-5703588

: @ - .

不允



厦门三优光电股份有限公司  
XIAMEN SAN-U OPTRONICS CO., LTD.

件 : -01-19-A-07-A08

: 02

: 20

## Mechanical Dimension and Pin A

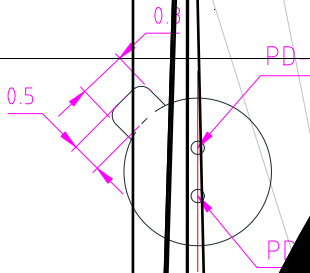

Bottom View

://

不允



件 : -01-19-A-07-A08 : 02 : 2018.11.21 3 共3

### Standard Product List:

	$\Phi_1$ ( )	$\Phi_2$ ( )	$i_1$ ( )	$i_1$ ( )	$i_2$ ( )	
D300- 25-B ( )-2 -A	2.5	1.96	3.35	12.7	12.7	D
D300- 25-B ( )-2 -B	2.5	1.96	3.35	14.0	14.0	
D300- 25-B ( )-2 -C	2.5	1.96	3.35	15.52	17.52	
D300- 25-B ( )-2 -A	2.5	1.96	2.92	12.7	12.7	
D300- 25-B ( )-2 -B	2.5	1.96	2.92	14.0	14.0	
D300- 25-B ( )-2 -C	2.5	1.96	2.92	15.52	17.52	

### Order Information:

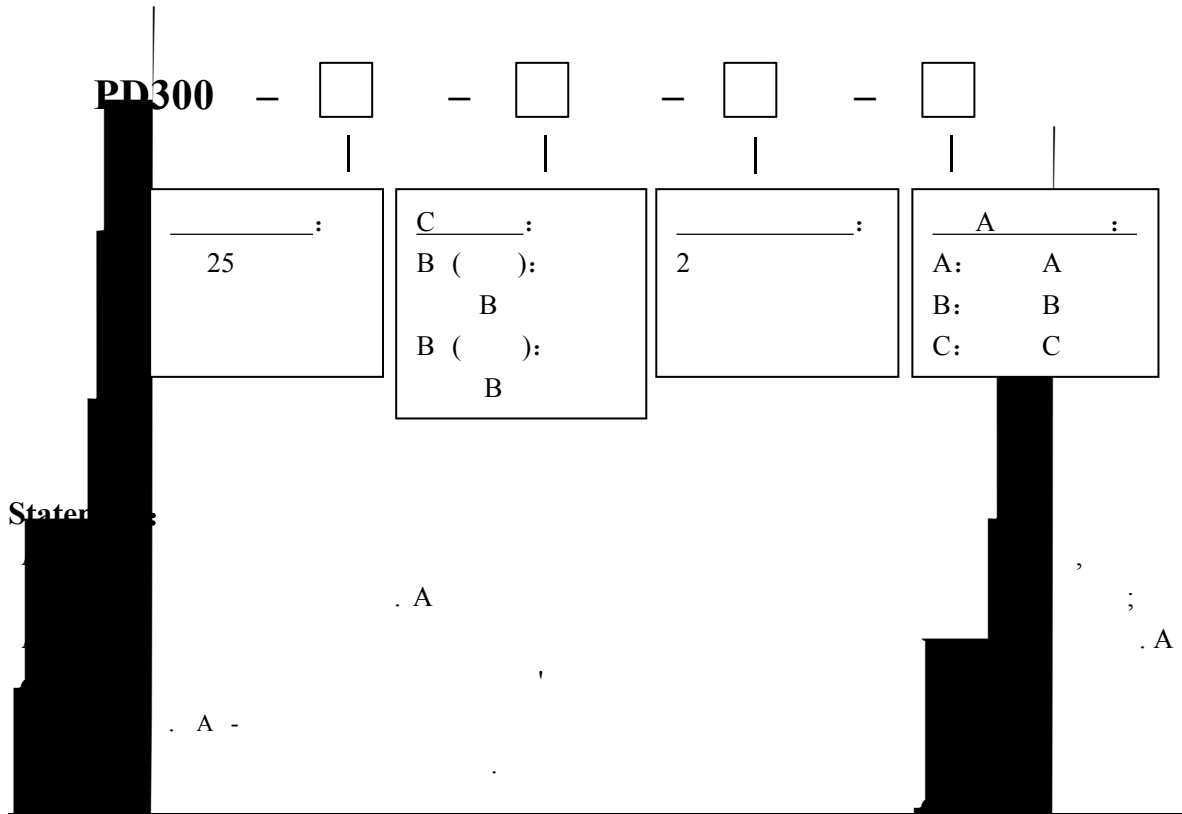

Information:  
501-505 B , C  
: +86-592-3898601, 3898608, 5318000  
: +86-592-5703588  
: @ - .  
:// - .

---

:// - . : +86-592-3898601 : +86-592-5703588 : @ - .